

## Historic Masonry Structures part 1



Parthenon interior

## Ziggurat

Mesopotamian

The Great Ziggurat of Ur

- In southern Iraq
- 2000 BC
- 210ft x 150ft x 100ft high  
(64m x 46m x 30m high)
- Clay brick core  
with fired brick skin
- Temple of moon god Nanna



# Early Egyptian

## Mastaba

- kings' burial sites
- Early (3000 BC) mud bricks
- By the 3<sup>rd</sup> Dynasty they used stone (2670 BC)



Mastabat al-Fir'aun of king Shepseskaf 2510 BC  
Red sandstone 325 ft x 250 ft x 30 to 60 ft high

## Early Stepped Pyramid

- Netjerikhet
- Made from stone
- 3<sup>rd</sup> Dynasty



The Step Pyramid of Netjerikhet is the oldest known building to be completely made of stone.

# Early Egyptian

## Bent Pyramid

- Initially 60° changed to 55°
- 2600 BC
- Cracking in base



Bent Pyramid at Dahshur



# Early Egyptian

Bent Pyramid at Dahshur



University of Michigan, TCAUP

Masonry

Slide 5 of 38

# Great Pyramid

Egyptian

Great Pyramid at Giza

- Last remaining “wonder”
- For king Khnum-Khufu
- 2580 – 2560 BC
- Near the capital of Memphis
- 756ft x 756ft x 481ft  
(230m x 230m x 147m)
- Slope of  $51^\circ$



Bent Pyramid at Dahshur

University of Michigan, TCAUP

Masonry

Slide 6 of 38

# Great Pyramid

Egyptian

Great Pyramid at Giza

- Construction in stone

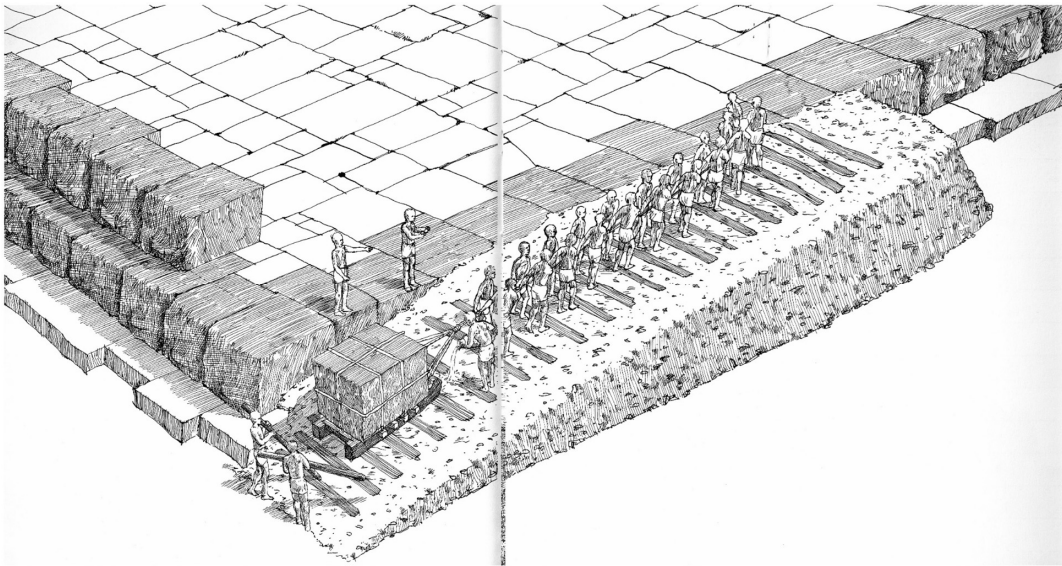

From David Macaulay *Pyramid*

University of Michigan, TCAUP

Masonry

Slide 7 of 38

# Great Pyramid

Great Pyramid at Giza

- Construction in stone

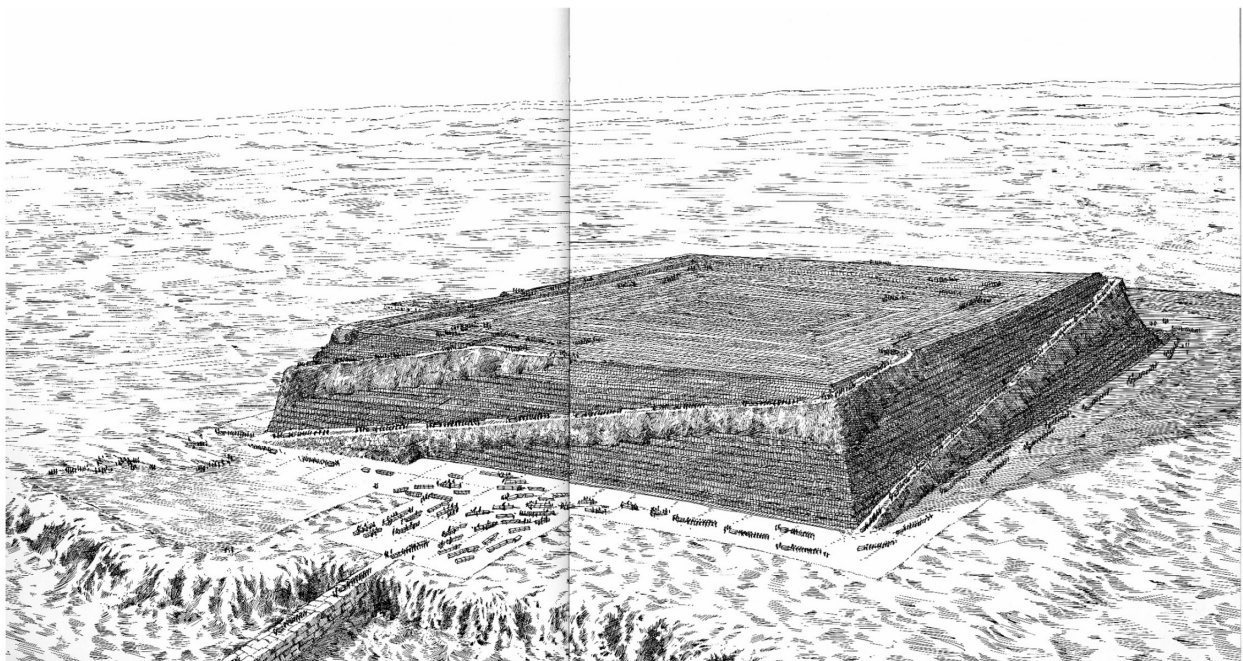

From David Macaulay *Pyramid*

University of Michigan, TCAUP

Masonry

Slide 8 of 38

# Great Pyramid

## Great Pyramid at Giza

- Construction in stone

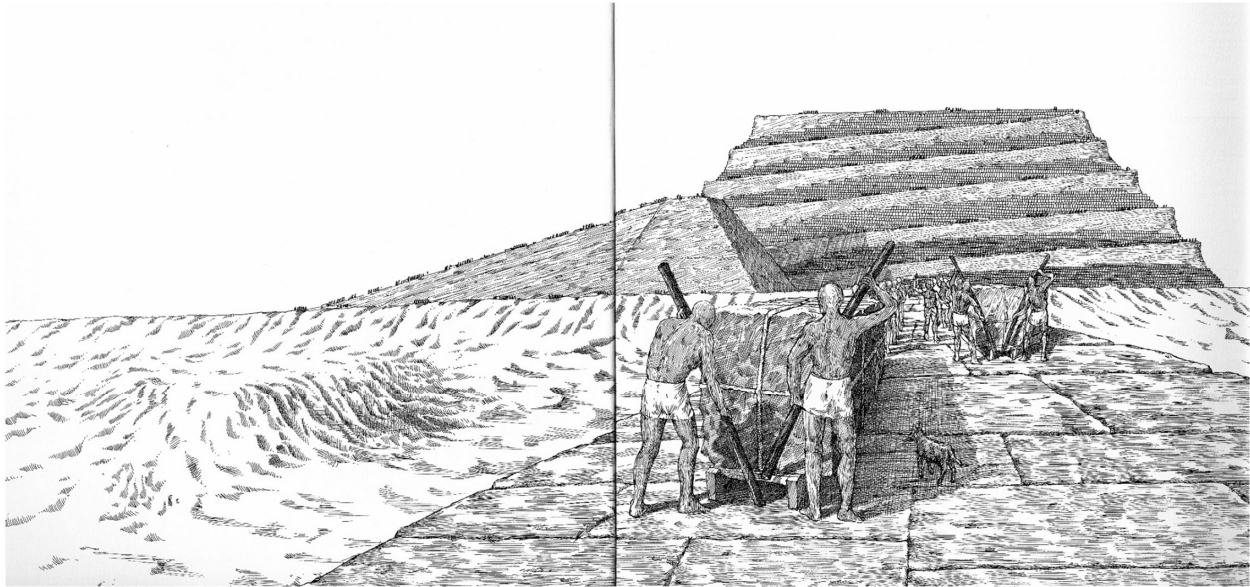

From David Macaulay *Pyramid*

University of Michigan, TCAUP

Masonry

Slide 9 of 38

# Great Pyramid

## Great Pyramid at Giza

- Construction in stone

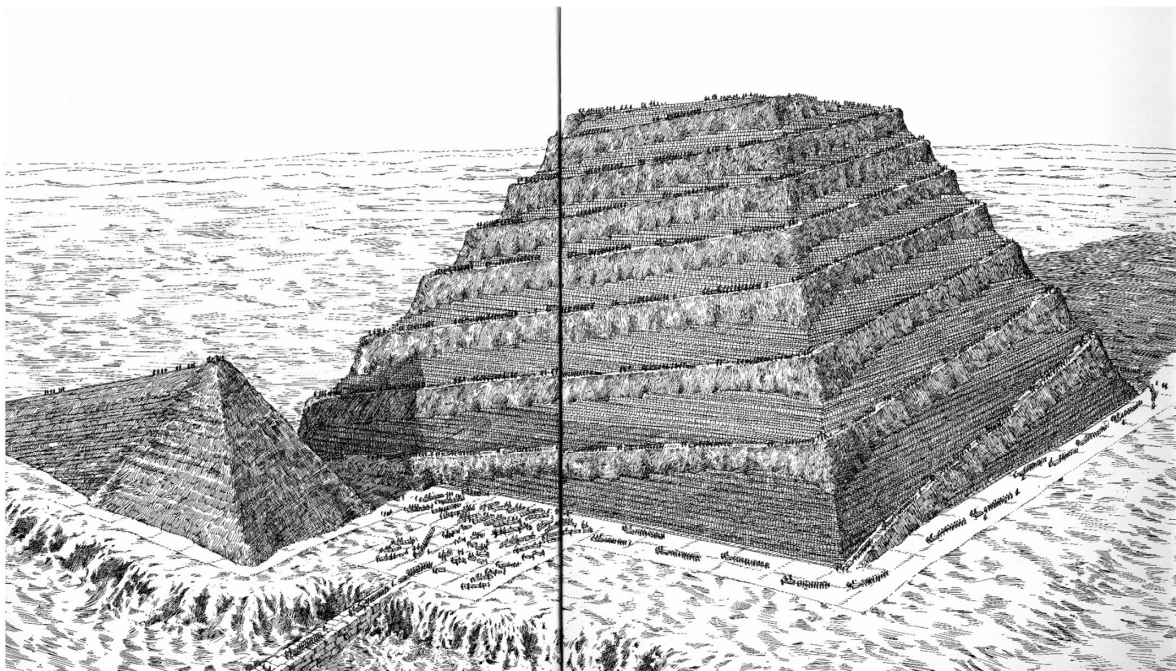

From David Macaulay *Pyramid*

University of Michigan, TCAUP

Masonry

Slide 10 of 38

# Great Pyramid

## Great Pyramid at Giza

- Construction in stone

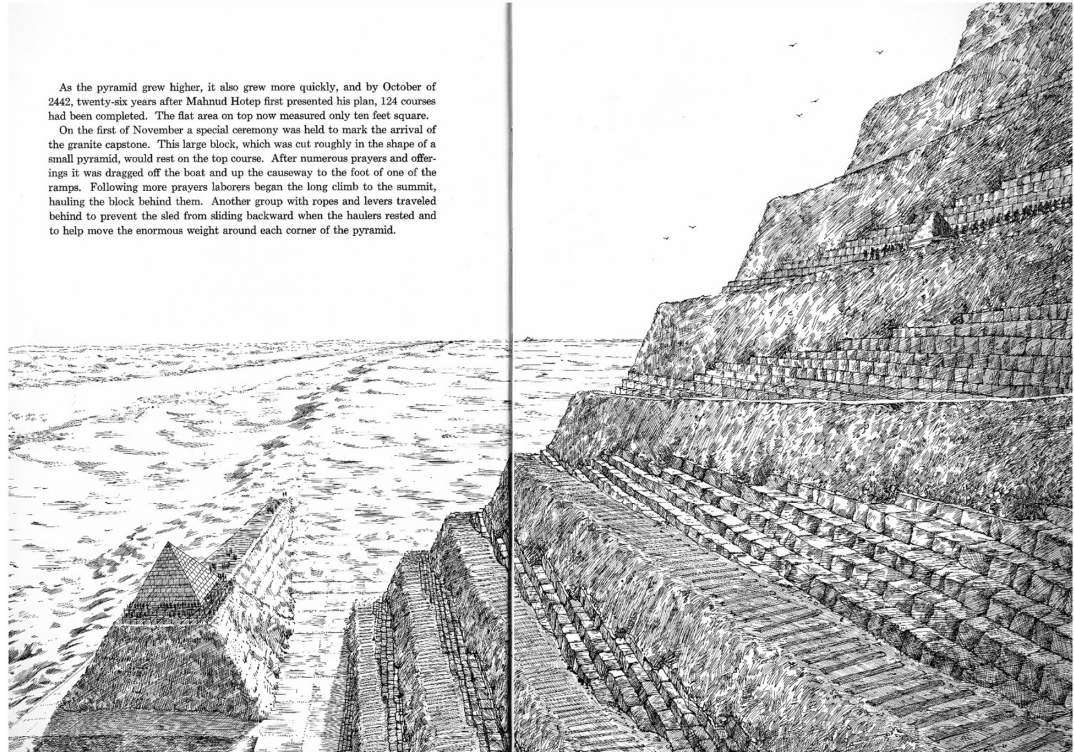

From David Macaulay *Pyramid*

University of Michigan, TCAUP

Masonry

Slide 11 of 38

# Great Pyramid

## Great Pyramid at Giza

- Construction in stone

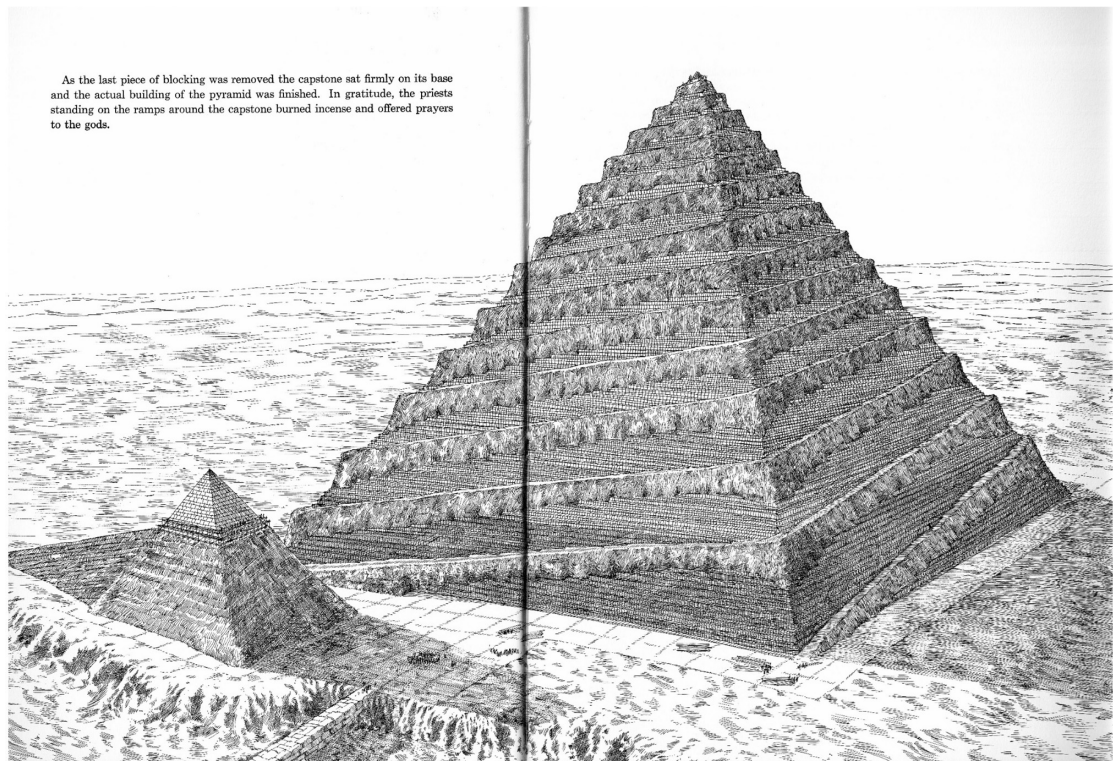

From David Macaulay *Pyramid*

University of Michigan, TCAUP

Masonry

Slide 12 of 38

# Great Pyramid

## Great Pyramid at Giza

- Construction in stone

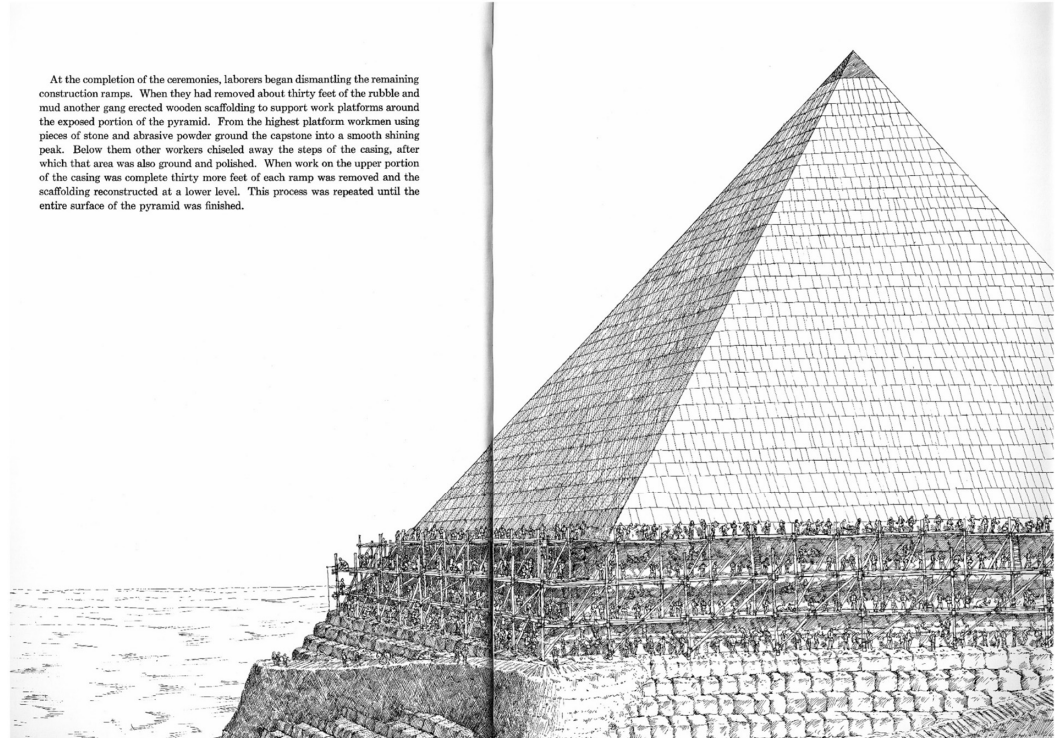

At the completion of the ceremonies, laborers began dismantling the remaining construction ramps. When they had removed about thirty feet of the rubble and mud another gang erected wooden scaffolding to support work platforms around the exposed portion of the pyramid. From the highest platform workmen using pieces of stone and abrasive powder ground the capstone into a smooth shining peak. Below them other workers chiseled away the steps of the casing, after which that area was also ground and polished. When work on the upper portion of the casing was complete thirty more feet of each ramp was removed and the scaffolding reconstructed at a lower level. This process was repeated until the entire surface of the pyramid was finished.

From David Macaulay *Pyramid*

University of Michigan, TCAUP

Masonry

Slide 13 of 38

# Great Pyramid

## Great Pyramid at Giza

- Construction in stone

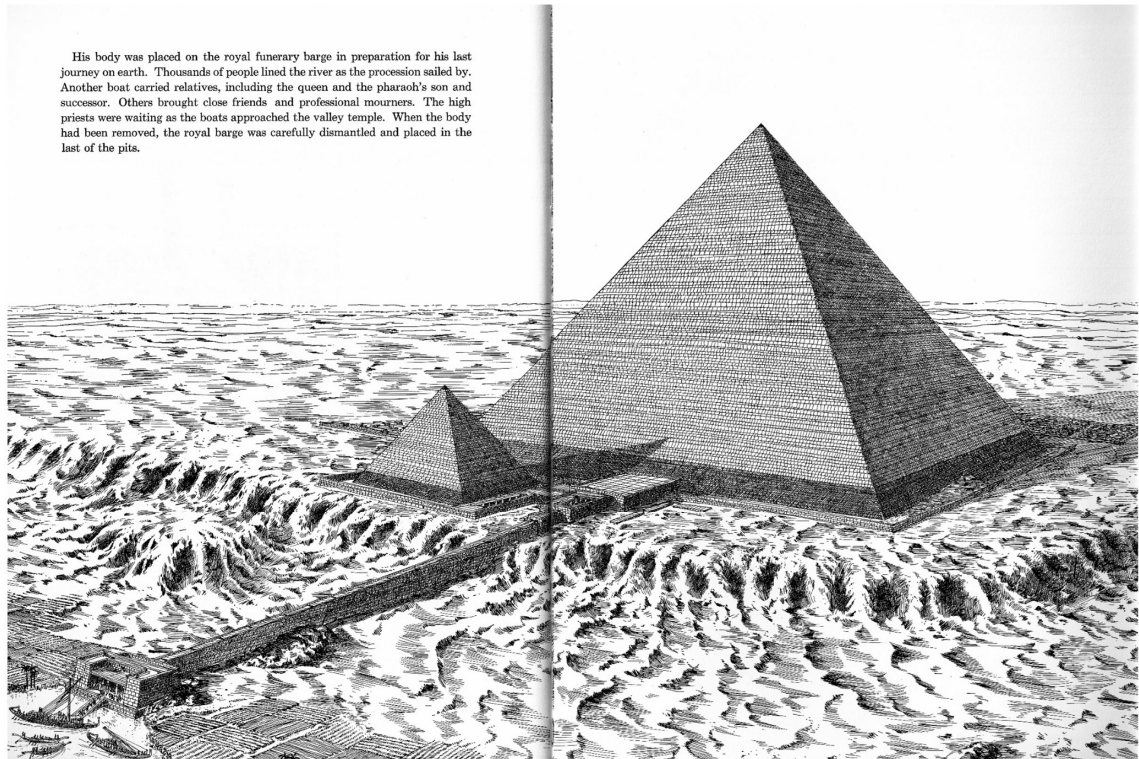

His body was placed on the royal funerary barge in preparation for his last journey on earth. Thousands of people lined the river as the procession sailed by. Another boat carried relatives, including the queen and the pharaoh's son and successor. Others brought close friends and professional mourners. The high priests were waiting as the boats approached the valley temple. When the body had been removed, the royal barge was carefully dismantled and placed in the last of the pits.

From David Macaulay *Pyramid*

University of Michigan, TCAUP

Masonry

Slide 14 of 38

# Great Pyramid

## Great Pyramid at Giza

- cast “stone” ?

### Chemical reaction 1:

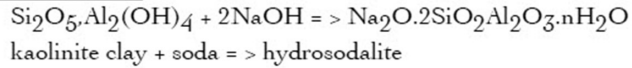

### Chemical reaction 2:

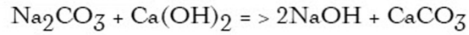

Sodium carbonate (Egyptian natron) + lime = > soda + limestone

## References:

### Summary of the re-agglomerated stone binder chemical formula:

clay + natron + lime = > feldspathoids + limestone (i.e. a natural stone)

pro

Joseph Davidovits, *Why the pharaohs built the Pyramids with fake stones*, 2009

<https://www.geopolymer.org/archaeology/pyramids/are-pyramids-made-out-of-concrete-1/>

or

con

Donald Campbell and Robert Folk, “Ancient Egyptian Pyramids – Concrete or Rock?”, *Concrete International*, Vol 13 Issue 8, August 1991

# Great Pyramid

## Great Pyramid at Giza

- Or cast “stone”

From Joseph Davidovits' book

Joseph DAVIDOVITS

Why the Pharaohs built  
**THE PYRAMIDS**  
with fake stones

The ULTIMATE scientific proofs  
The rise and decline of a technology

GEOPOLYMER



# Great Pyramid

## Great Pyramid at Giza

- Or cast "stone"

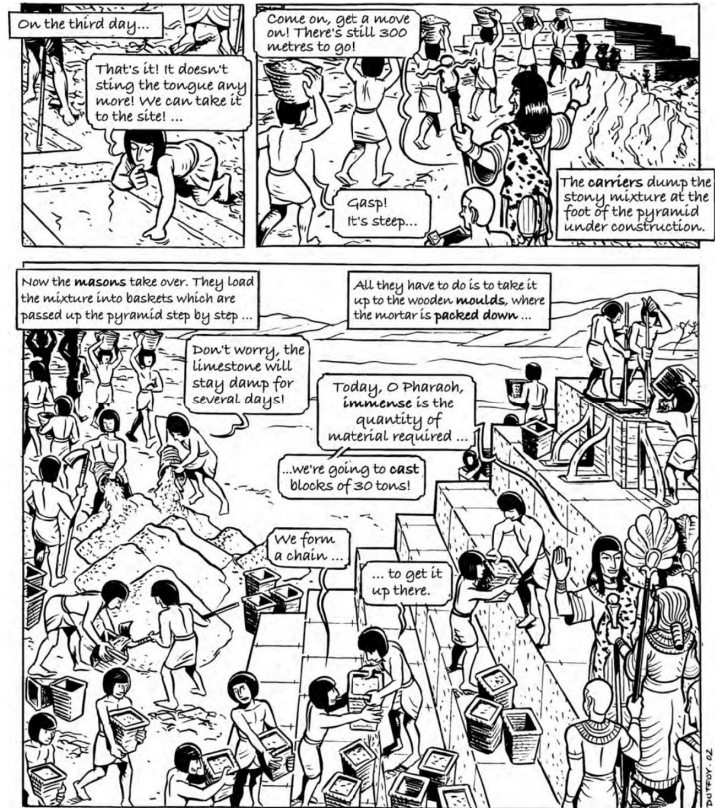

From Joseph Davidovits

# Pyrament

## Pyrament from Lone Star

- Geopolymer cement
- Cures faster
- High strength

Used in bridge decks in Kentucky ~ 1995

[https://uknowledge.uky.edu/ktc\\_researchreports/846/](https://uknowledge.uky.edu/ktc_researchreports/846/)

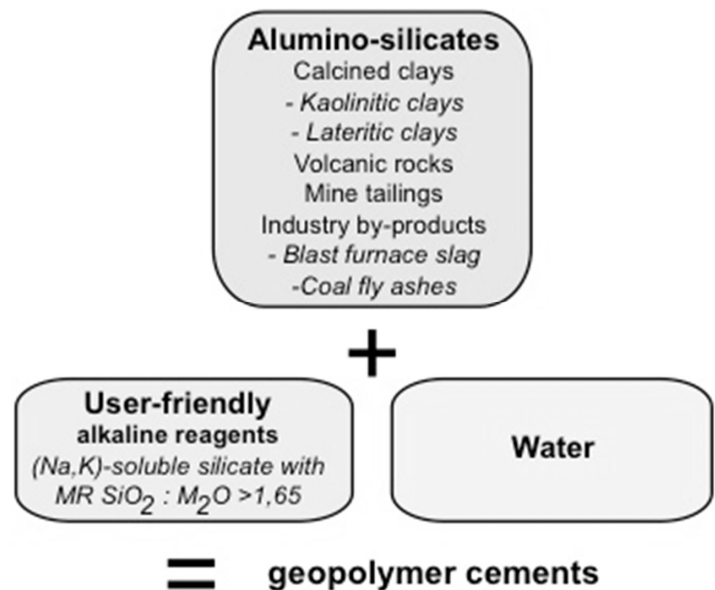

# Great Pyramid

Joseph Davidovits

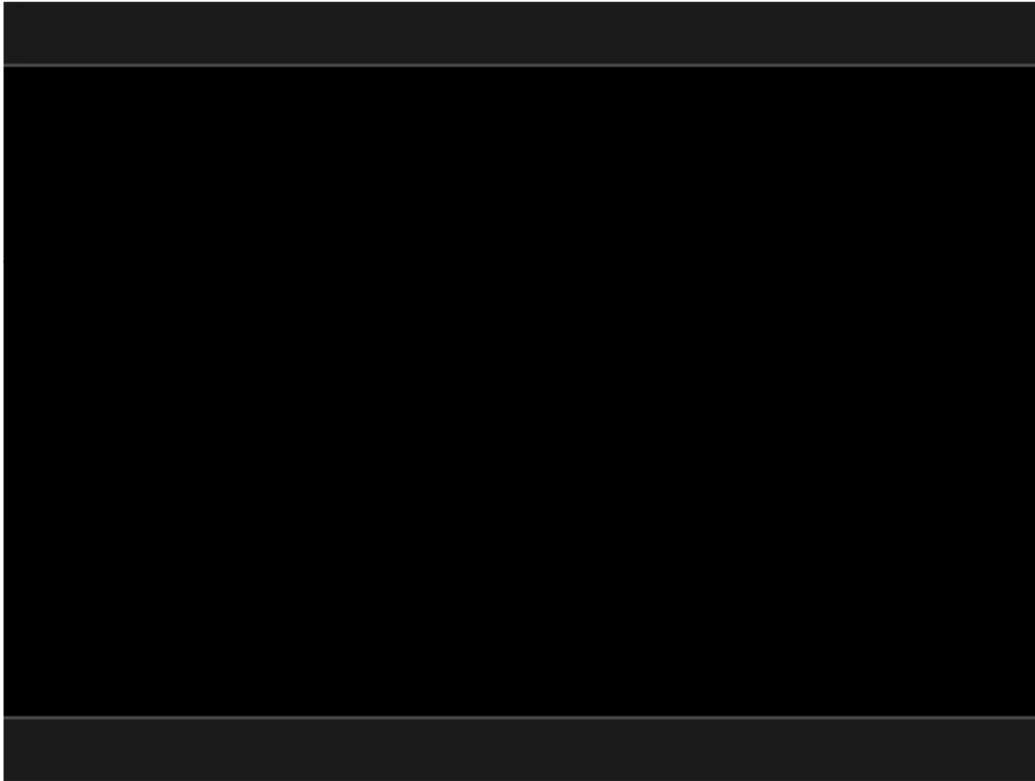

<https://www.youtube.com/@geopolymer/videos>

University of Michigan, TCAUP

Masonry

Slide 19 of 38

## Corbeled Arch

Greek

Lion Gate

- Mycenae
- 1250 BC
- Corbeled “arch”
  
- Stone lintel
- 3 ft thick
- 30 ton



University of Michigan, TCAUP

Masonry

Slide 20 of 38

# Corbeled Arch

Greece

Treasury of Atreus at Mycenae

- 1250 BC



Syria

Royal Palace of Ugarit

- 1400 - 1200 BC



University of Michigan, TCAUP

Masonry

Slide 21 of 38

# Corbeled Arch

India

Billbee-ubud

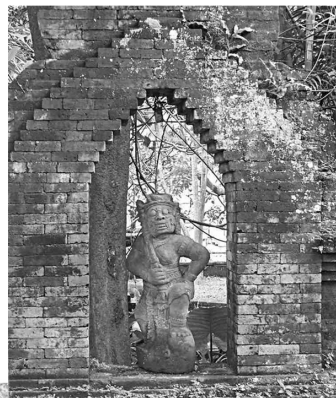

Maya

Cahal Pech

- 250 AD

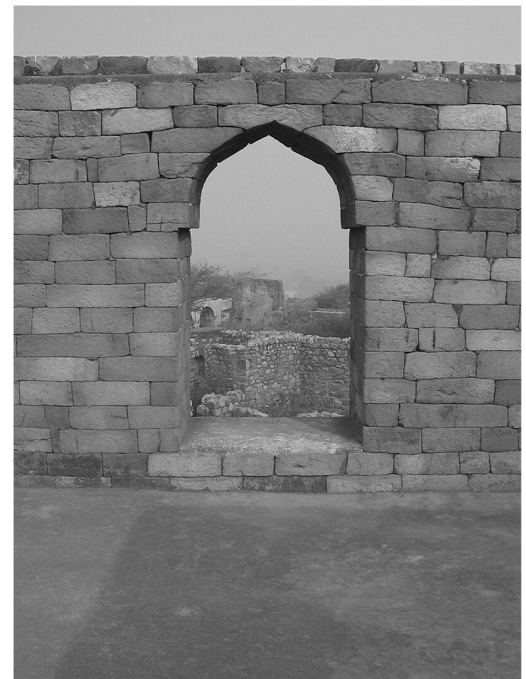

Trabeate Arch – New Delhi

University of Michigan, TCAUP

Masonry

Slide 22 of 38

# Post & Lintel

Greek

Temple form

- Derived from wood construction
- “architecton” is master carpenter
- Stone replaced wood by 700 BC

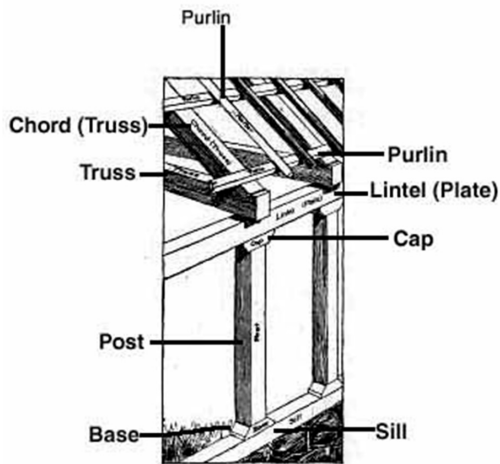

FIG. 7—NEW HAMPSHIRE BARN FRAME

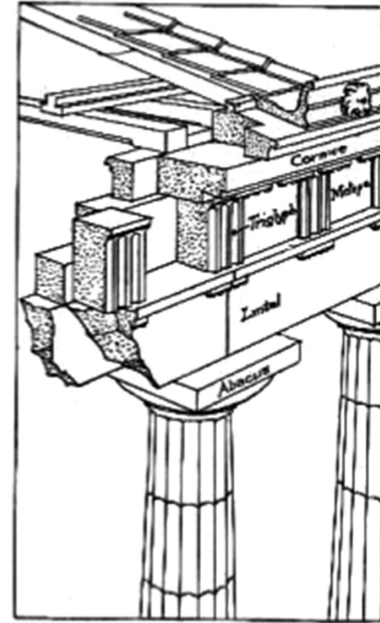

FIG. 8—GREEK STONE CONSTRUCTION

# Post & Lintel

Greek

Parthenon

- 447- 438 BC
- Blown up in 1687 in Turkish War



# Post & Lintel

Nashville

Parthenon

- Original in wood 1897
- 1925 exterior
- 1931 interior
- 1990 statue



University of Michigan, TCAUP



Masonry

Slide 25 of 38

# Wall Construction

Roman

Fired brick used in walls

- Solid masonry
- Infill with concrete (pozzolanic)

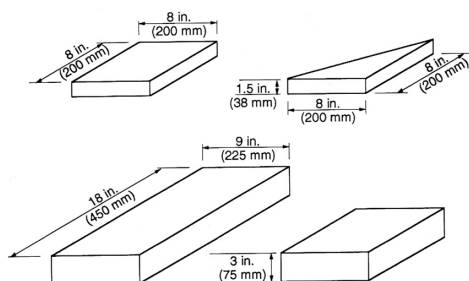
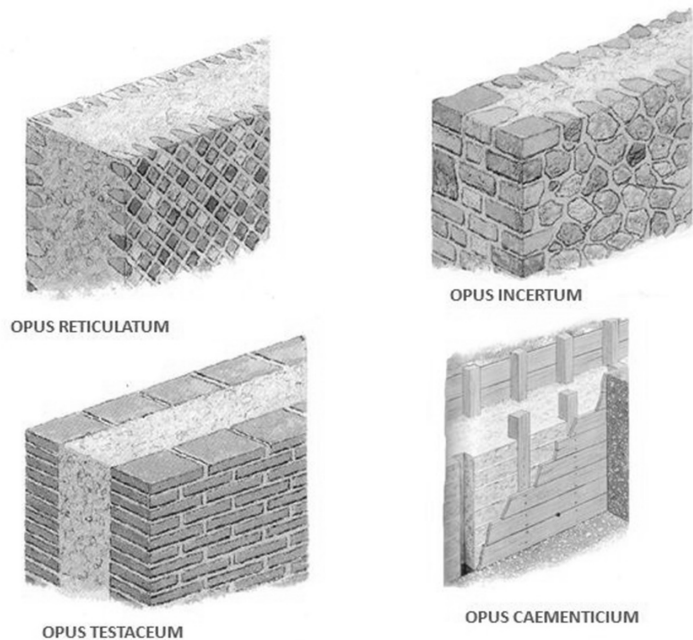

Figure 1.3 Roman bricks made in a mold.



University of Michigan, TCAUP

Masonry

Slide 26 of 38

# Wall Construction

## Roman

Fired brick used in walls

- Solid masonry
- Infill with concrete (pozzolanic)

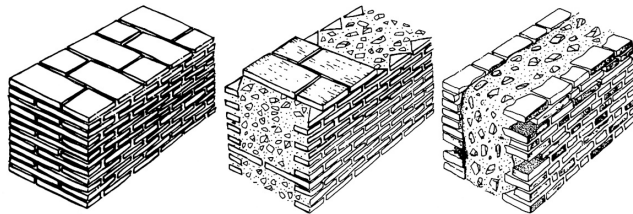

(a) Bonded Brick Wall

(b) Brick Faced Wall with Header Courses

(c) Brick Faced Wall

Figure 1.7 Roman masonry walls.



Elevation

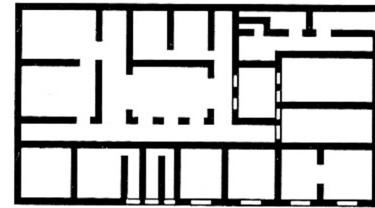

Plan

## Apartments in Ostia

# Arches

## Roman

The arch

- First to use
- Circular form
- Braced sides

Ostia



# Arches

## Arch forms

- catenary
- parabolic
- circular

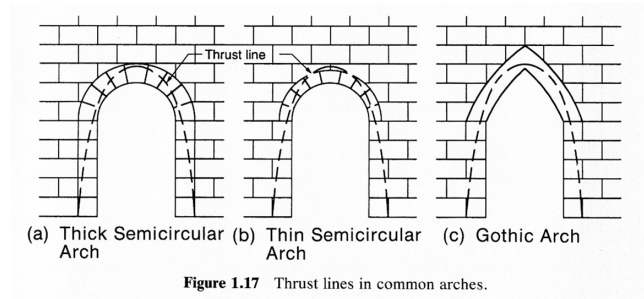
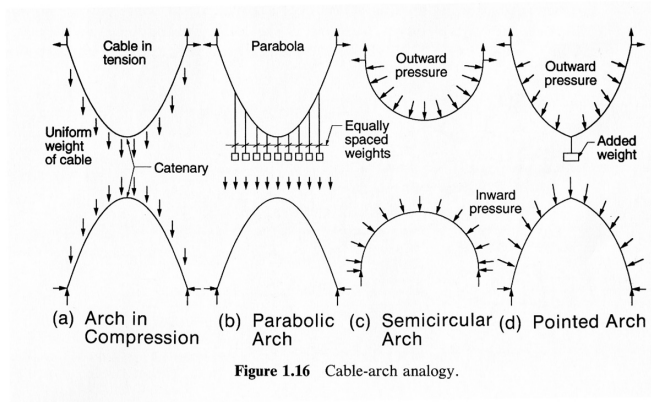

# Arches

## Arch forms

- catenary
- parabolic
- circular

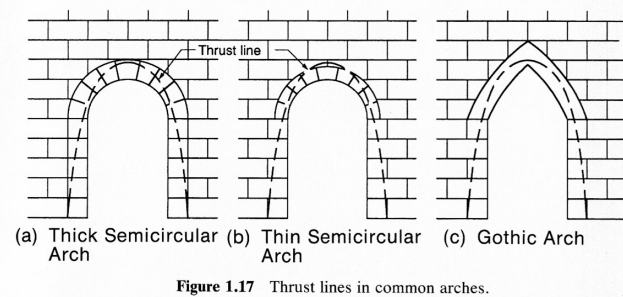
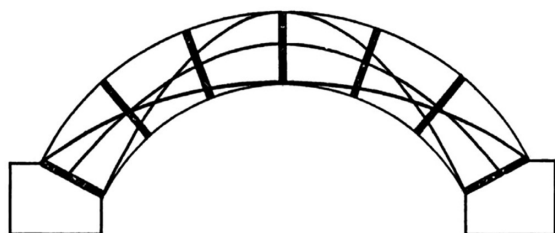
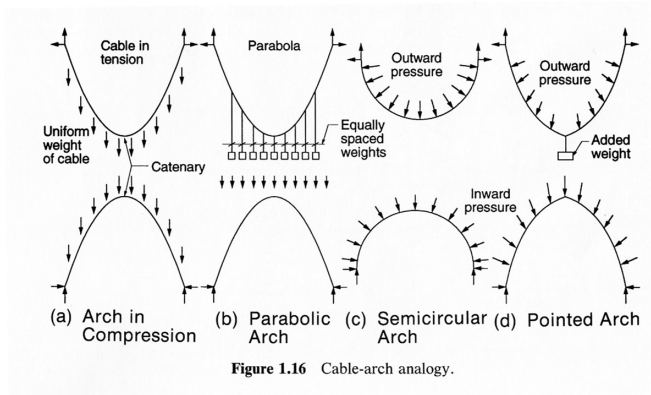

# Arches

## Arches – thrust line calculation

- Sum moments at section

TWO COUPLES ARE EQUAL

$$W \times \frac{L}{4} = R \times h$$

$$R = \frac{WL}{4h}$$

TRACE THE THRUST LINE BY CUTTING A SECTION.

$\Sigma M$  TO FIND  $a$

$$\Sigma M_{O} = 0$$

$$-\frac{WL}{4h} a + W \frac{L}{4} - \frac{W}{2} \frac{L}{8} = 0$$

$$\frac{WL}{4h} a + \frac{WL}{4} = \frac{WL}{4}$$

$$a = \frac{3}{4} \frac{WL}{WL} \cdot \frac{h}{WL}$$

$$a = \frac{3}{4} h$$

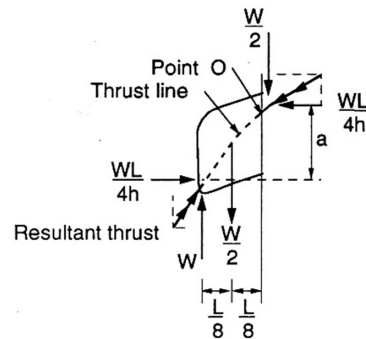
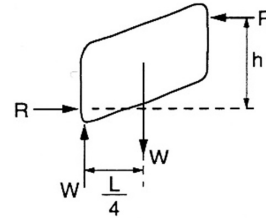
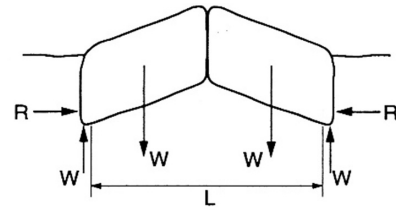

# Arches

## Arches – thrust line calculation

- Sum moments at section

Two examples with different contact bearing points

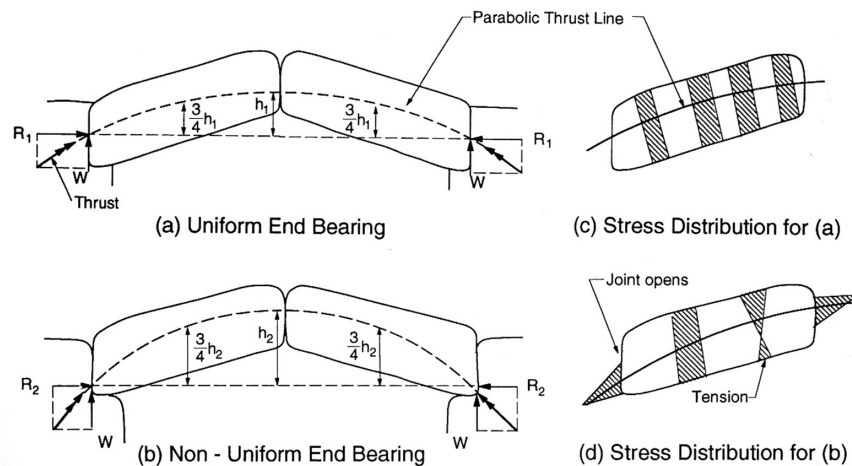

Figure 1.14 Thrust lines and stresses in inclined lintels (primitive arches).

# Arches

Roman

The arch

- First to use
- Circular form
- Braced sides



# Arches Roman arch bridge

